

ELECTROMOTIVE DRIVE

ECO ETS

HARMONIOUS DOOR MOVEMENT – MOTOR-POWERED OPENING – CONTROLLED CLOSING



ETS 42

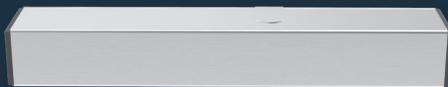

ETS 73

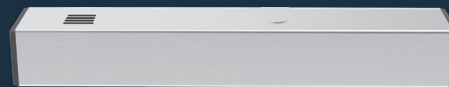

ETS 64-R IRM

Performance criteria

Performance criteria		ETS 73	ETS 64-R	ETS 42
Closing force	Size acc. to EN (continuously adjustable)	3 – 7	3 – 6	2 – 4
Door width acc. to EN	Interior doors ≤ 1.100 mm			■
	Interior doors ≤ 1.600 mm	■		
	Fire protection doors ≤ 1.400 mm		■	
Dimensions (incl. mounting plate)	Length in mm	690	690	730
	Depth in mm	120	120	125
	Height in mm	95	95	70
Force		up to 400 kg (for door leaves up to 1100 mm)	up to 250 kg (for Fire- and Smoke proofed doors)	up to 150kg
Ambient temperature		-15 to +50° C		
Relative humidity		max. 85%		
Power consumption		max. 560 W (standby 4 W)		
DIN left / right		■	■	■
Opening speed adjustable		max. 40°/s		
Closing speed	adjustable with mains operation, fixed if there is a power failure	max. 40°/s		
Hold-open time adjustable		0 - 60s		
Max. door opening angle		105°		
Tested acc. to EN		DIN 18650 EN 16005	DIN 18263-4 DIN 18650 EN 16005	DIN 18650 EN 16005
	Suitable for fire- and smoke control doors	-	F (DIBt)	-
Certified according to EU-Directive		CE		
<div style="display: flex; justify-content: space-around; align-items: center;"> <div style="text-align: center;"> <p>Wooden door</p> </div> <div style="text-align: center;"> <p>Steel door</p> </div> <div style="text-align: center;"> <p>Profile frame door</p> </div> </div> <p>■ Ja - Nein □ Option</p>				

Drawings

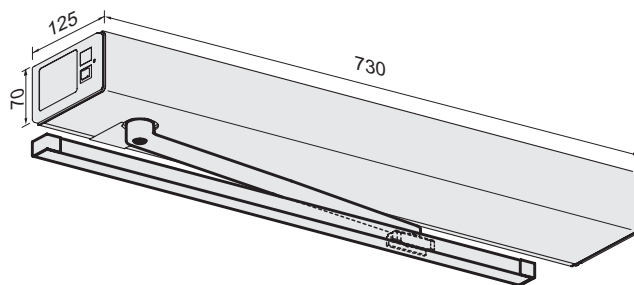

Dimensions: ETS 42 with slide rail

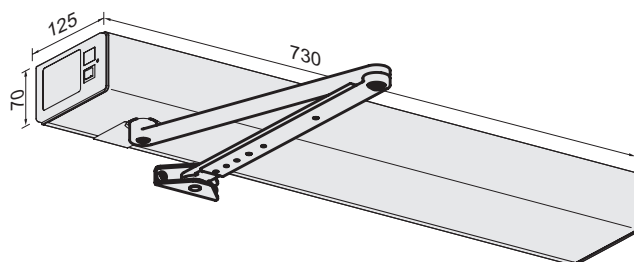

Dimensions: ETS 42 with standard arm

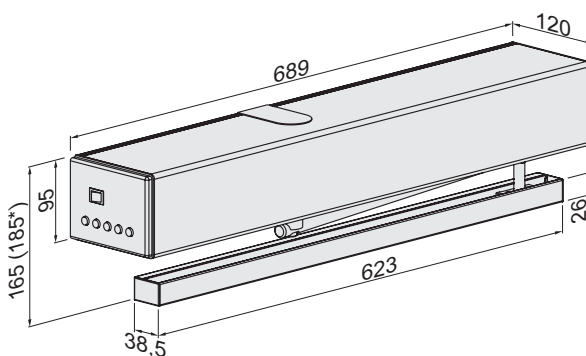

Dimensions: ETS 73 / ETS 64-R with slide rail

* In the case of rebated doors please use the long pins (included in delivery).



Models and functions

- Slide rails pushing (opposite hinge side) and pulling (hinge side)
- Normal arm pushing (opposite hinge side)
- 1 and 2-door structures with continuous cover
- Integrated, concealed door control for fire/smoke protection doors (in the universal cladding)
- Integrated, concealed smoke sensor (integrated in the covering hood, can be retrofitted (DIBt, EN 54-7))
- Adjustable spring closing pressure (when cut off from the electricity mains)
- Easy operation with illuminated program selection keys in the side cover (automatic, always on, manual, exit and night)
- The main switch separating all poles is integrated in the side cover
- Push + Go function, easy responsiveness
- Adjustable starting power and closing power amplification (for pressing shut into the lock)
- Adjustable start delay (motorised lock, closing sequence)
- Plug + Play, setup of functions with LCD display
- Low Energy operation without safety sensor technology
- Very low standby consumption (4 Watts)
- Connectable wind load compensation, max. wind speed 80 km/h (320 Pa)
- Connectable acoustic signal of opening and/or closing movement

Arm variations



Slide rail for ETS



Standard arm for ETS
(For lintel depth up to 250 mm)

Accessories

Flatscan

DIN 18650 **EN 16005**

Sensor for swing doors to secure the entire width and height of the door leaf on the hinge side or opposite hinge side, as well as the secondary closing edge.



Sensor strips

DIN 18650 **EN 16005**



Active infrared safety sensor for automatic doors. Secures the movement area. Stops or reverses when obstacles are identified.

Integrated closing sequence selector (SRI)

Assembly set for retrofitting an ETS 64-R two-leaf catch system with an integrated, mechanical door control. Approved by the DIBt. (Medium cladding set necessary).

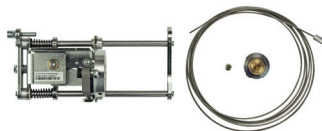

Cladding for double leaf doors

Assembly set for retrofitting an ETS 64-R two-leaf catch system with an integrated, mechanical door control. Approved by the DIBt. (Medium cladding set necessary).

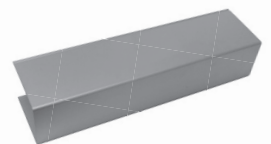

■ SYSTEM TECHNOLOGY FOR THE DOORTÜR



ECO Schulte GmbH & Co. KG
Iserlohner Landstraße 89
D-58706 Menden

Telefon +49 2373 9276 - 0
Telefax +49 2373 9276 - 40

info@eco-schulte.de
www.eco-schulte.de

